

# MEGATEK

## Portable DVD Player

PD-1256

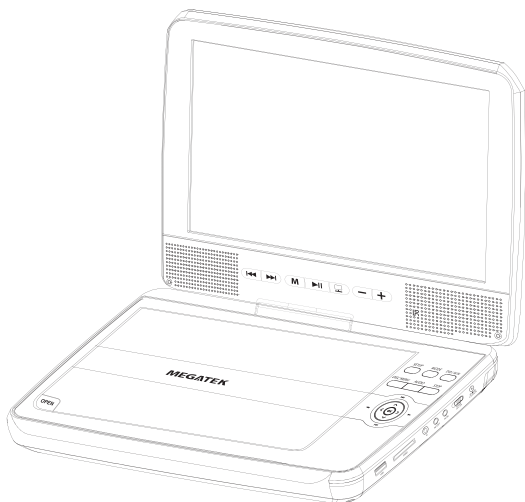

## User's Manual

**One (1) Year Full Replacement for Defective Product.**

Questions or Problems? Contact Us:

✉ [service@megatekelec.com](mailto:service@megatekelec.com)

📧 Amazon Buyer-Seller Messaging



**NOTE**

1. Car charger only compatible with 12V car cigarette lighters. Use of DC power outlet higher than 12V in an automobile will damage the unit.
2. Please avoid touching the lens.
3. Please charge at least once a month if not used for long periods.
4. Please fully charge the DVD player before using.
5. It is highly recommend recharging this DVD player every 3 months. Please keep the cell under half charge statue, neither fully charge or discharge if long term storage.

# Contents

---

## 1 Safety instructions 4

---

## 2 Your portable DVD player 6

Introduction	6
What's in the box	6
Overview of the main unit	7
Overview of the remote control	11

---

## 3 Get started 15

Charge the battery	15
Install remote control battery	16

---

## 4 Use your player 17

Turn on	17
Select OSD language	17
Play DVD/CD discs	17
Play USB/memory cards	18
Use the AV Output	19
Use the AV Input	20

---

## 5 Adjust settings 21

---

---

<b>6</b>	<b>Product information</b>	23
<hr/>		
<b>7</b>	<b>Troubleshooting</b>	24
<hr/>		
<b>8</b>	<b>12 Months Warranty</b>	26

# 1 Safety instructions

1. Read these instructions.
2. Keep these instructions.
3. Heed all warnings.
4. Follow all instructions.
5. Do not use this apparatus near water.
6. Clean only with dry cloth.
7. Do not block any ventilation openings. Install in accordance with the manufacturer's instructions.
8. Do not install near any heat sources such as radiators, heat registers, stoves, or other apparatus (including amplifiers) that produce heat.
9. Protect the power cord from being walked on or pinched, particularly at plugs, convenience receptacles, and the point where they exit from the apparatus.
10. Only use attachments/accessories specified by the manufacturer.
11. Use only with the cart, stand, tripod, bracket, or table specified by the manufacturer or sold with the apparatus. When a cart is used, use caution when moving the cart/apparatus combination to avoid injury from tip-over.
12. Unplug this apparatus during lightning storms or when unused for long periods of time.
13. Refer all servicing to qualified service personnel. Servicing is required when the apparatus has been damaged in any way, such as power-supply cord or plug is damaged, liquid has been spilled or objects have fallen into the apparatus, the apparatus has been exposed to rain or moisture, does not operate normally, or has been dropped.
14. Batteries (battery pack or batteries installed) shall not be exposed to excessive heat such as sunshine, fire or the like.
15. Apparatus shall not be exposed to dripping or splashing.
16. Do not place any sources of danger on the apparatus (e.g. liquid filled objects, lighted candles).
17. This product may contain lead and mercury. Disposal of these materials may be regulated due to environmental considerations. For disposal or recycling information, please contact your local authorities or the Electronic Industries Alliance: [www.eiae.org](http://www.eiae.org).
18. Where the MAINS plug or an appliance coupler is used as the disconnect device, the disconnect device shall remain readily operable.

## Warning

- Never remove the casing of this apparatus.
- Never lubricate any part of this apparatus.
- Never place this apparatus on other electrical equipment.
- Keep this apparatus away from direct sunlight, naked flames or heat.
- Never look into the laser beam inside this apparatus.
- Ensure that you always have easy access to the power cord, plug or adaptor to disconnect this apparatus from the power

## FCC Notice:

FCC Statement: this device complies with Part 15 of the FCC Rules. Operation is subject to the following two conditions:

(1) This device may not cause harmful interference, and (2) This device must accept any interference received, including interference that may cause undesired operation.

Note: This equipment has been tested and found to comply with the limits for Class B digital devices, pursuant to Part 15 of the FCC rules. These limits are designed to provide reasonable protection against harmful interference in a residential installation. This equipment generates, uses and can radiate radio frequency energy and, if not installed and used in accordance with the instructions, may cause harmful interference to radio communications. However, there is no guarantee that interference will not occur in a particular installation. If this equipment does cause harmful interference to radio or television reception, which can be determined by turning the equipment off and on, the user is encouraged to try to correct the interference by one or more of the following measures:

- Reorient or relocate the receiving antenna.
- Increase the separation between the equipment and receiver.
- Connect the equipment into an outlet on a circuit different from that to which the receiver is connected.
- Consult the dealer or an experienced radio/TV technician for help.

Use of shielded cable is required to comply with Class B limits in Subpart B of Part 15 of the FCC rules.

Do not make any changes or modifications to the equipment unless otherwise specified in the manual. If such changes or modifications should be made, you could be required to stop operation of the equipment.

## 2 Your portable DVD player

Congratulations on your purchase of a high-quality Megatek product.

Your PD-1256 is designed for reliable and trouble free performance, we wish you great satisfaction in using it.

---

### Introduction

Your portable DVD player plays digital video discs that conform to the universal DVD Video standard. With it, you can play movies with true cinema picture quality and stereo or multi-channel sound (depending on disc and playback set-up).

You can also select sound track, subtitle languages, and different angle of view (again depending on DVD disc). Besides, you can restrict the play of discs that are not suitable for children.

You can play the following discs on the DVD player (including CD-R, CD-RW, DVD±R and DVD±RW):

- DVD-Video
- Video CD
- Audio CD
- MP3 CD
- Discs with JPEG files

---

### What's in the box

Check and identify the contents of your package:

- Portable DVD player
- Remote control
- AC power adaptor,
- Car adaptor
- AV cables
- Car mounting pouch
- User Manual



## Overview of the main unit

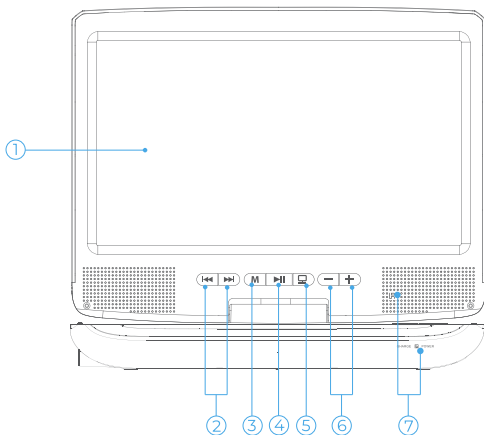

### ① Display panel

### ② Skip ◀◀ ▶▶

- Skips to previous title/chapter/track or next title/chapter/track.
- Switches the PBC menu pages for VCD version 2.0 or SVCD with PBC turned on.

### ③ M (Mode)

- Selects a playback mode: DVD, USB, or SD.

### ④ Play / Pause ▶▶

- Starts, pauses or resumes disc/USB/card play.

### ⑤

- Turns on/off TFT LCD screen.

⑥ Volume

- Increases or decreases volume.

⑦ CHARGE /  / POWER

- Charging indicator/Remote control sensor/Power indicator.

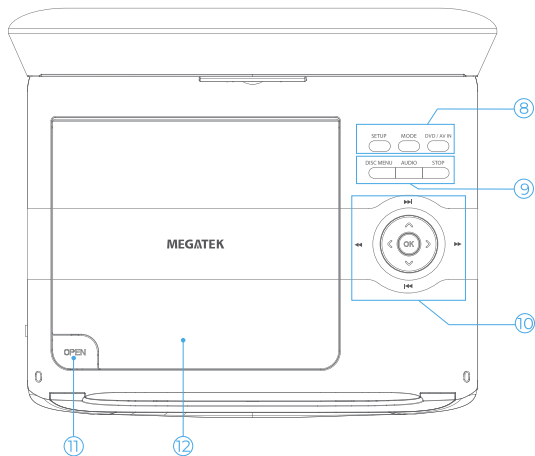

⑧ Setup

- Accesses or exits the setup menu.

Mode

- Selects a playback mode: DVD, USB, or SD/MMC card.

DVD / AV IN

- Switches between DVD and AV IN Mode.

### 9 Disc Menu

- For DVD, accesses or exits disc menu.
- For VCD, turns on or off PBC (Playback Control) mode.

#### Audio

- For DVD, selects an audio language.
- For VCD, selects an audio mode.

#### Stop

- Stops disc/USB/card play. In stop mode, the unit is still consuming power.

### 10 Skip ◀◀ ▶▶

- Skips to the previous or next title, chapter, or track.
- Switches the PBC menu pages for VCD version 2.0 or SVCD with PBC turned on.

#### Search ◀▶

- Searches backward or forward at different speeds.

#### OK

- Confirms an entry or selection.
- Starts, pauses or resumes disc/USB/card play.

### 11 Open

- Opens the disc compartment.

### 12 Disc Compartment

- When inserting a disc, ensure that it's label side is facing the right way up.

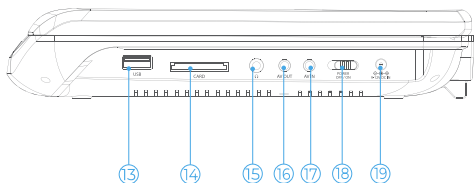

**13 USB Port**

- Connects a USB device.

**14 Card Port**

- Connects a SD/MMC Card device.

**15** 

- Headphone jack.

**16 AV Out**

- Audio/video output jack.

**17 AV IN**

- Audio/video input jack.

**18 POWER ON/OFF**

- Turns on/off DVD player.

**19 DC IN**

- Power supply socket.

## Overview of the remote control

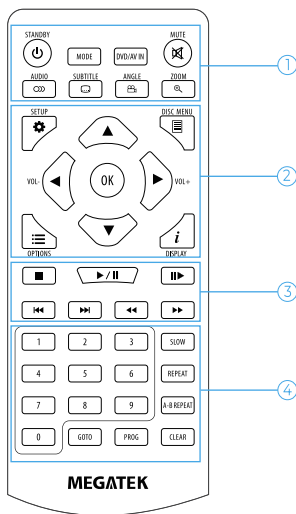

### ① Standby/Power On

- Press to switch the unit from on to standby mode or vice versa. In standby mode, the unit is still consuming a small amount of power.

### MODE

- Selects a playback mode: DVD, USB, or SD/MMC card.

### DVD / AV IN

- Switches between DVD and AV IN mode.

### MUTE

- Press to enable/disable the audio output.

## AUDIO

- For DVD, selects an audio language.
- For VCD, selects an audio mode.

## SUBTITLE

- Selects DVD subtitle language.

## ANGLE

- Selects a different viewing angle of a DVD.

## ZOOM

- Zooms in or out.

## ② SETUP

- Accesses or exits the setup menu.

### Disc Menu

- For DVD, accesses or exits disc menu.
- For VCD, turns on/off PBC (Playback Control) mode.



- Navigates menus.
- Rotates JPEG images.
- Scrolls when zooming in.

### VOL-/VOL+

- Decreases or increases volume.

### OK

- Confirms an entry or selection.
- Starts, pauses or resumes disc play.

### OPTIONS

- While playing a DVD or VCD, press to access options relating to the current activity or selection, if available.

### DISPLAY *i*

- Displays play information.

### ③ STOP ■

- Stops disc/USB/card play. In stop mode, the unit is still consuming power.

### PLAY/PAUSE ►/||

- Starts, pauses or resumes disc/USB/card play.

### FRAME ||►

- Press once to pause playback, then press repeatedly to step forward one frame at a time. Press PLAY ►/|| to resume normal playback.

### Skip ◀◀ ▶▶

- Skips to the previous or next title, chapter, or track.
- Switches the PBC menu pages for VCD version 2.0 or SVCD with PBC turned on.

### Search ◀◀ ▶▶

- Searches backward or forward at different speeds.

### ④ Numeric Keypad 0 - 9

- Input numbers.

### SLOW

- Press to begin slow motion playback. Press repeatedly to step through slow speeds. Press PLAY ►/|| to resume normal playback.

### REPEAT

- Press during playback to step through repeat options, including repeat current chapter/track/title, repeat entire disc, shuffle play, and off.

### A-B REPEAT

- Press once to set the start of a repeat loop. Press again to set the end of the repeat loop and start repeat playback. Press again to cancel repeat.

### GO-TO

- Specifies the point of time where you would like to start playback.

## PROGRAM

- Sets the playback order.
  1. Press ◀ ▶ ▲ ▼ to select the item.
  2. Press 0 to 9 to specify the 2-digit order.

e.g.     5:     0 → 5  
          15:    1 → 5

To cancel: Press CLEAR.

3. Press ◀ ▶ ▲ ▼ to select Start, press OK to start programmed playback.
4. Press STOP ■ twice to clear the whole program.

## CLEAR

- Deletes the number you just input.



# 3 Get started

## Charge the battery

### ! Caution

- Risk of product damage! Ensure that the power supply voltage corresponds to the voltage printed on the bottom of the player.
- Use only the supplied AC adaptor to charge the battery.

### Note

- The car adapter is compatible with DC 9-12V power outlet in an automobile only. Use of DC power outlet higher 12V in an automobile will damage the unit.

- 1 Slide the **POWER ON/OFF** switch to OFF position.

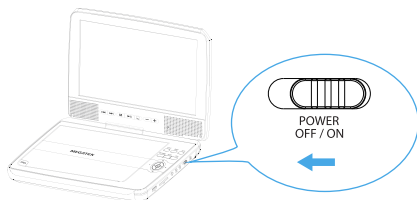

- 2 Connect the supplied AC adaptor to the player and to the AC (100-240V, 50/60Hz) outlet, or connect the supplied DC Power Car Adapter to the player and to the DC 9-12V Power Outlet in an automobile.

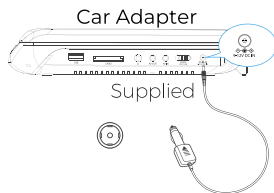
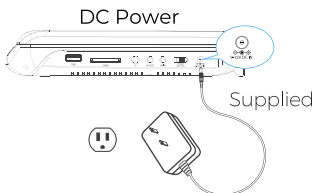

- ↳ The CHARGE indicator turns on (red). It takes about 4 hours to fully charge the battery.
- ↳ When the battery is fully charged, the CHARGE indicator turns green.

## Install remote control battery



### Caution

- Risk of explosion! Keep batteries away from heat, sunshine or fire. Never discard batteries in fire.
- Danger of explosion if battery is incorrectly replaced. Replace only with the same or equivalent type.
- Batteries contain chemical substances, they should be disposed of properly.

To install or replace the remote control batteries:

- 1 Open the battery compartment.
- 2 Insert 2 AAA batteries with their polarities (+/-) matching those marks in the remote control's battery compartment.
- 3 Close the battery compartment till you hear a click sound.

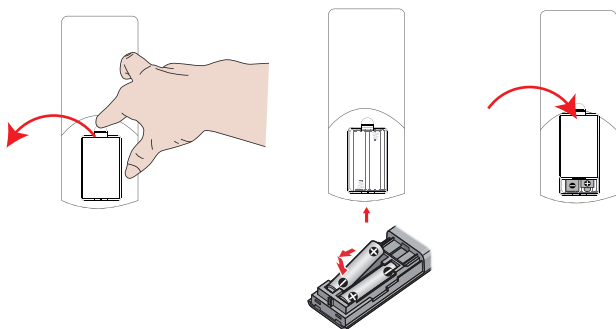

## 4 Use your player

---

### Turn on

Slide the **POWER ON/OFF** switch to the ON position.

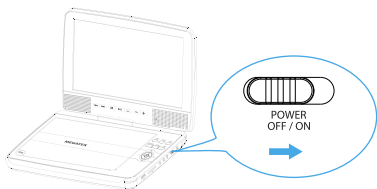

↳ The **POWER ON/OFF** indicator turns on (green).

---

### Select OSD language

You can choose a different language for the on-screen display text.

- 1 Press **SETUP**.  
The setup menu appears.
- 2 Use navigation keys to select **[General] > [OSD Language]**.
- 3 Press **▶** to select an option.
- 4 Press **OK** to confirm.
- 5 Press **SETUP** to exit.

---

### Play DVD/CD discs

#### Note

- Please remove the protective card inside the disc compartment, if any, before first-time use.

- 1 Press **OPEN** button on the player.
- 2 Insert the disc with label side facing up.
- 3 Push down to close the disc compartment.  
↳ Play starts automatically. If not, press **▶/||/OK**.

If a menu appears, select an item, then press ►/||/OK to start play.

To pause, press ►/||/OK. Press again to resume play.

To stop, press STOP twice.

To select the previous/next item, press ◀◀ or ▶▶.

To start search within video/audio, press ◀◀ or ▶▶ once or more.

---

## Play USB/memory cards

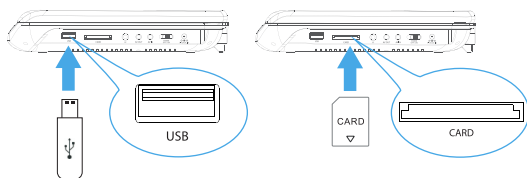

- 1 Insert a USB flash drive into the USB port, or an SD/MMC memory card into the CARD slot. The unit will automatically switch to **USB** or **Card mode** when it is not playing a disc.
- 2 Press **M/Mode** button repeatedly to select **USB** or **Card** mode, when necessary.  
A menu showing the contents of the inserted **USB** or **Card** will display on the screen.
- 3 Press **▲/▼** to select a file or a folder.
- 4 Press **OK** to enter the selected folder, the files/folders within it will be listed.
- 5 Press **►/||/OK** to start playing the selected file. Press it again to pause the play.
- 6 Press **■** to stop the play.

### Note

- Supports FAT32 format (NTFS not supported).
- Supports capacity up to 128GB.
- Supports MPEG4 files with 720x576 or 720x480 video resolutions only. Not all MPEG4 files are supported.
- This unit does not guarantee connection with all USB devices.
- This unit does not support USB charging.

## Use the AV Output



### Caution

- Turn off your player before connecting to any additional equipment.

### Note

- When connecting two products using an RCA Cable, match the color of the AV cables with the jacks. (Red to Red, White to White, and Yellow to Yellow)

- 1 Connect the 3.5mm - RCA Cable (included) to the AV Output on the unit and the audio/video (AV) inputs on the Television.
- 2 Slide the **POWER ON/OFF** switch to the ON position to turn on the unit.
- 3 Change the television to the correct audio/video input setting.
- 4 Audio and video played through the unit will now be seen and heard on the connected television.

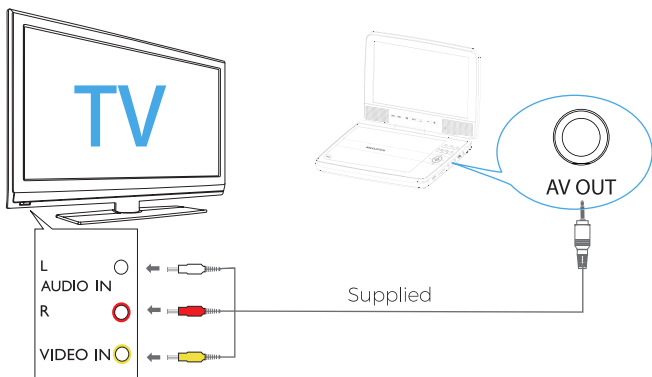

## Use the AV Input

### Caution

- Turn off your player before connecting to any additional equipment.

### Note

- When connecting two products using an RCA Cable, match the color of the AV cables with the jacks. (Red to Red, White to White, and Yellow to Yellow)

- 1 Connect the 3.5mm - RCA Cable (included) to the **AV Input** on the unit and the audio/video outputs on the DVD Player or Television.
- 2 Slide the **POWER ON/OFF** switch to the ON position to turn on the unit.
- 3 Press the **DVD/AV IN** Button to switch the unit to AV IN mode.
- 4 Adjust the DVD Player or Television to the correct audio/video output setting.
- 5 Audio and video played through the DVD Player or Television will now be seen and heard on the unit.

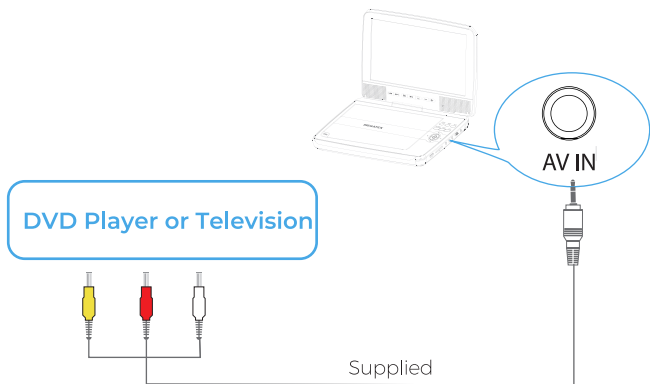

## 5 Adjust settings

To maximize your play experience, use SETUP to fine tune your settings.

- 1 Press **SETUP**.
  - ↳ The setup menu is displayed.
- 2 Use navigation keys to select an option and press **OK** to confirm.

### General Setup Page

[TV Display]	Set screen display aspect ratio.
[Angle Mark]	Turn on/off the angle mark. When the Angle Mark is on, an icon will appear on-screen to indicate that DVD supports different angle views.
[OSD Lang]	Select on-screen display language.
[Captions]	Turn on/off Closed Captioning (CC).
[Screen Saver]	Turn on/off the screen saver.
[Last Memory]	Turn on/off resume playback.

### Audio Setup Page

[Speaker Setup]	<b>DOWNMIX</b> – Select how the player downmixes multi-channel audio to stereo output: <ul style="list-style-type: none"><li>• <b>LT/RT</b> - 2-channel output, main channel with surround.</li><li>• <b>STEREO</b> – 2-channel output, main right channel with right surround and main left channel with left surround.</li></ul>
-----------------	--

### Panel Quality Setup

[Panel Quality]	Set the Brightness, Contrast, Hue, and Saturation for the LCD screen.
-----------------	---

## Preference Page

[TV Type]	Set video output format to TV system: NTSC (by default), PAL.
[Audio]	Select an audio language.
[Subtitle]	Select DVD subtitle language.
[Disc Menu]	Select disc menu language.
[Parental]	Select parental options.
[Password]	Change existing password (136900 by default).
[Default]	Restore factory settings.

- 3 Press ◀ to go back to the previous menu.
- 4 Press **SETUP** to exit.



# 6 Product information

## Note

- Product information is subject to change without prior notice.

Dimensions	253 x 41 x 205mm
Weight	1.0 kg
Power supply	Input: 100-240V~ 50/60Hz Output: DC 12V=== 1.5A
Power consumption	18W
Operating temperature range	0-45°C
Laser wavelength	650 nm
Video output	1 Vp-p75 Ohm unbalanced
Format	PAL & NTSC
Output level	1Vp - p ± 20%
Load impedance	75Ω
Audio line out	1.4V Rms/ 10K Ohm
Audio out (analog audio)	Output level: 1.4V ± 10%
Load impedance	10 KΩ
Audio distortion + noise	≤80 (1KHz)
Frequency response	20Hz-20KHz ± 1dB
Signal/noise ratio	≥80 dB
Channel separation	≥80 dB
Dynamic range	≥85 dB

# 7 Troubleshooting



## Warning

- Risk of electric shock. Never remove the casing of the player.

To keep the warranty valid, never try to repair the system yourself. If you encounter problems when using the player, check the following points before requesting service. If the problem remains unsolved,

**contact us via email:**

service@megatekelec.com.

### No power

- Ensure that both plugs of the mains cord are properly connected.
- Ensure that there is power at the AC outlet.
- Check if the built-in battery is drained.

### No sound

- Ensure that the AV cable is connected correctly.

### Distorted picture

- Clean the disc. With a clean, soft, lint-free cloth, wipe the disc outwards from the center.
- Make sure that the video output format of the disc is compatible with the TV.
- Change the video output format to match your TV or program.
- The LCD is manufactured using high precision technology. You may, however, see tiny black points and/or bright points (red, blue, green) that continuously appear on the LCD. This is a normal result of the manufacturing process and does not indicate a malfunction.

### Cannot play disc

- Ensure the disc label is upwards.
- Clean the disc. With a clean, soft, lint-free cloth, wipe the disc outwards from the center.
- Check if the disc is defective by trying another disc.

### **No response to the remote control**

- Ensure that the path between the remote control and the player is clear from obstacles.
- From a close distance, point the remote control directly at the player.
- Replace the remote control batteries.
- The function does not work for this disc. Refer to the disc instructions.

### **The player feels warm**

- When the player is in use for a long period of time, its surface will be heated. This is normal.

# 12 Months Warranty

Thank you for choosing Megatek.

Megatek Electronics warrants your new product to be free from defects in materials and workmanship for a period of twelve (12) months, from the date of receiving. This warranty is in addition to your rights under Amazon's return and refund policies which apply to your purchase.

Megatek will provide you with a brand-new replacement (where possible) for this product if it becomes defective within the warranty period. Megatek will bear the reasonable expense of claiming the warranty. This warranty will no longer apply where the defect is a result of alteration, accident, misuse, abuse, or neglect.

Please contact our Customer Service with your order ID and description of the problem, for warranty claim or any difficulties with your product:

**Email: [service@megatekelec.com](mailto:service@megatekelec.com)**

**Amazon Buyer-Seller Messages:** Go to Your Orders then find your order in the list, open the order and on the order page click **Get help** button.



## **One (1) Year Full Replacement for Defective Product.**

Questions or Problems? Contact Us:

✉ [service@megatekelec.com](mailto:service@megatekelec.com)

 Amazon Buyer-Seller Messaging

